

SITE, GRADING, & EROSION CONTROL PLAN

UNIT 38-39
GENEVA NATIONAL CONDOMINIUM
NO. 38

LOCATED IN TOWN 2 NORTH, RANGE 17 EAST
WALWORTH COUNTY, WISCONSIN

CONSTRUCTION SEQUENCE

- 1) SILT FENCING INSTALLED
- 2) VEGETATION TO BE CLEARED
- 3) TOPSOIL STRIPPED
- 4) FOUNDATIONS DUG & POURED
- 5) WALLS BACKFILLED
- 6) FRAMING & HOME CONSTRUCTION COMPLETED
- 7) DRIVE & LANDSCAPING COMPLETED

AREA TO BE RESTORED WITH TOPSOIL AS SOON AFTER
FOUNDATION AND FRAMING AS POSSIBLE FOLLOWED WITH
GRASS SEEDING AND MULCH.

NO LARGE TRIBUTARY DRAINAGE CROSSES THIS LOT,
ONLY LOCALIZED LOT DRAINAGE.

AREA WITHIN SILT FENCING TO BE CLEARED OF
UNDERBRUSH WITH ONLY NECESSARY LARGE TREES
REMOVED.

NO WETLAND OR FLOODPLAIN EXISTS ON THIS LOT.

NOTE: ALL SILT FENCING AND BAILE CHECKS SHALL BE MAINTAINED IN A STABLE
CONDITION FULLY BRACED AND STAKED TO PREVENT MOVEMENT BY RUNOFF UNTIL A
DENSE TURF IS ESTABLISHED OVER ALL DISTURBED GROUND SURFACES. DURING OR
AFTER EVERY STORM THEY SHALL BE CHECKED. ACCUMULATIONS OF SILT TOPSOIL
AND ANY OTHER CONSTRUCTION DEBRIS SHALL BE ROUTINELY REMOVED.

WORK ORDERED BY
STEVE SCHULZ - SUNRISE HOMES
534 PHEASANT RIDGE LANE
FONTANA, WI 53125

FARRIS, HANSEN & ASSOCIATES, INC.
Engineering, Architecture, Surveying
7 Ridgway Court P.O. Box 437
ELKHORN, WISCONSIN 53121
Office: (262) 723-2098
Fax: (262) 723-5886

REVISIONS

PROJECT NO.
3269.38-39
DATE:
01/06/03
SHEET NO.
1 OF 1

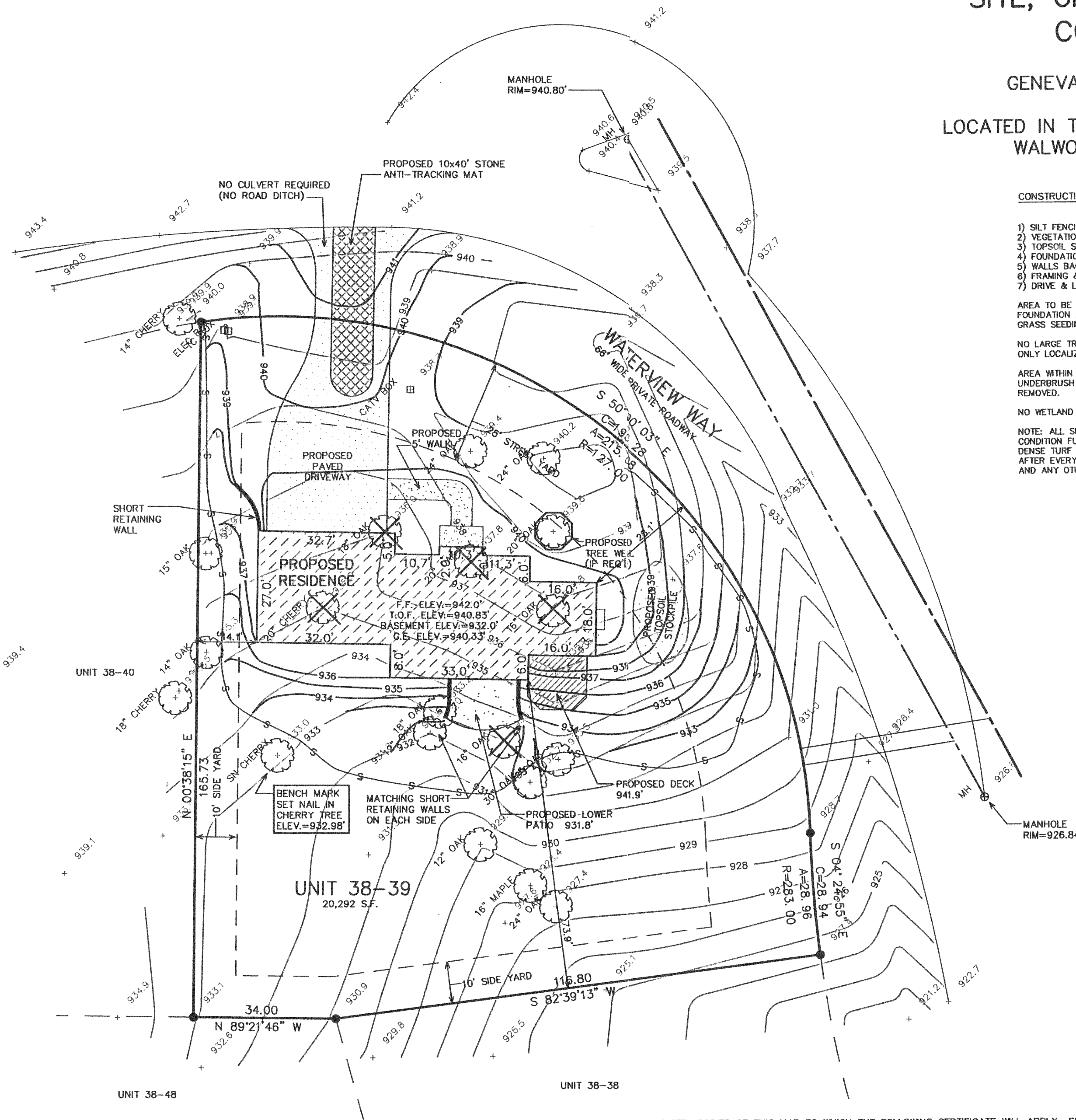
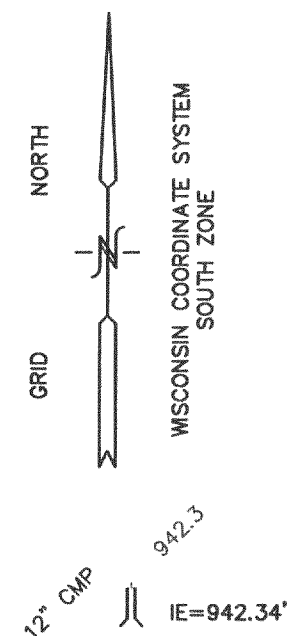

- = FOUND IRON REBAR STAKE
- (xxx) = RECORDED AS
- S— = PROPOSED SILT FENCE
- xxx— = EXISTING CONTOURS
- xxx— = PROPOSED CONTOURS
- ⊗ = TREE TO BE REMOVED

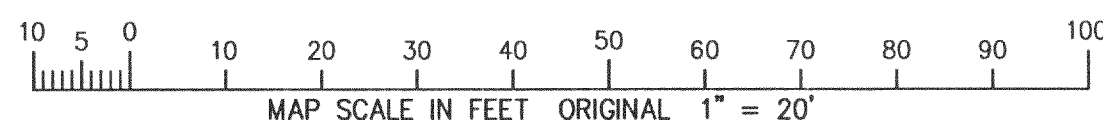

NOTE: COPIES OF THIS MAP TO WHICH THE FOLLOWING CERTIFICATE WILL APPLY SHOW SURVEYOR'S ORIGINAL
SEAL AND SIGNATURE IN RED INK. COPIES BY ANY OTHER MEANS MAY HAVE ALTERATIONS WHICH DO NOT REPRESENT THE SURVEYOR'S
WORK PRODUCT.

I HEREBY CERTIFY THAT THE ABOVE DESCRIBED PROPERTY HAS BEEN SURVEYED UNDER MY DIRECTION AND THAT THE ABOVE MAP IS A TRUE
REPRESENTATION THEREOF AND SHOWS THE SIZE AND LOCATION OF THE PROPERTY AND ITS EXTERIOR BOUNDARIES. THIS SURVEY IS MADE
FOR THE USE OF THE PRESENT OWNERS OF THE PROPERTY, AND ALSO THOSE WHO PURCHASE, MORTGAGE, OR GUARANTEE THE TITLE THERETO
WITHIN ONE YEAR FROM THE DATE HEREOF.

DATED: 1/16/2003

PETER S. GORDON R.L.S. 2101

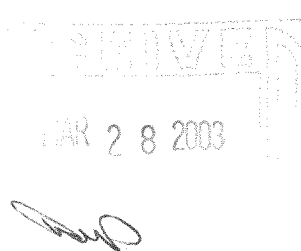

JAN 16 2003

JGN38-39

217-2589